

Data sheet: Star-Z NOVA

Pump curves

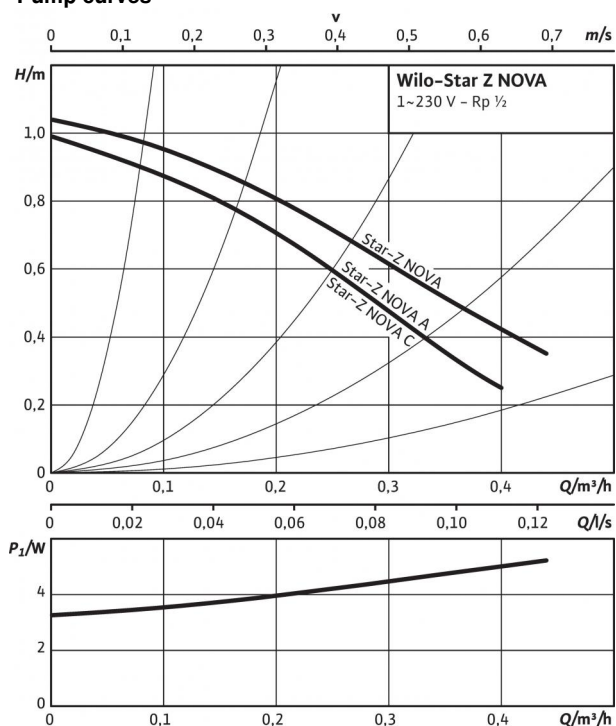

Dimension drawing Star-Z NOVA

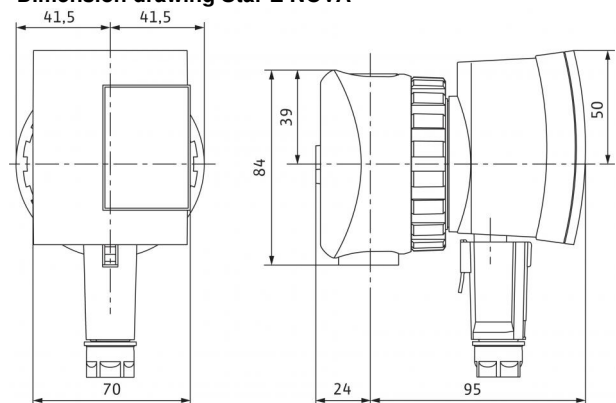

Terminal diagram

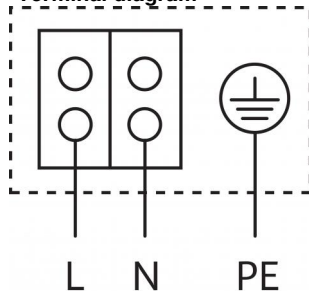

Blocking current-proof motor
Single-phase motor (EM) 2-pole - 1~230 V, 50 Hz

Approved fluids (other fluids on request)

Drinking water and water for food-processing companies in accordance with TrinkwV 2001 (drinking water ordinance)

Permitted field of application

Temperature range for applications in domestic hot water circulation systems at max. ambient temperature of +40 °C in short-time duty 2 h T

Temperature range for applications in domestic hot water circulation systems at maximum ambient temperature of +40 °C

Max. permitted total hardness in domestic hot water circulation systems

Maximum permissible operating pressure P_{\max}

70 °C

+2 °C... +65 °C

3.57 mmol/l (20 °dH)

10 bar

Pipe connections

Threaded pipe union

Nominal flange diameter

Overall length L0

R ½

DN 15

84 mm

Motor/electronics

Emitted interference

Interference resistance

Protection class

Insulation class

Mains connection

Speed n

Power consumption P_1

Current consumption I

Motor protection

Screwed cable connection connector

EN 61000-6-3

EN 61000-6-2

IP 42

F

1~230 V, 50 Hz

3000 rpm

3 - 5 W

max. 0.05 A

Not required (blocking-current proof)

11 PG

Materials

Pump housing

Impeller

Pump shaft

Bearing

Brass (CuZn40Pb2)

Plastic (PPE/PS - 30% GF)

Ceramic

Carbon, synthetic resin impregnated

Minimum suction head at suction port for avoiding cavitation at water pumping temperature

Minimum suction head at 40 / 65 °C

0.5 / 2 m

Information for order placements

Make

Type

Art no.

Weight approx. m

Wilo

Star-Z NOVA

4132750

0.9 kg

Dimensions and dimensions drawings: Star-Z NOVA

Dimension drawing

